



270 Grafton Street

, Portsmouth, PO2 7LJ

£240,000

Family Home | 3 Good Size Bedrooms | Central Location | Ample Parking for up to 4 Cars | Close to the Motorway for Commuters | Downstairs Toilet | Ideal for First Time Buyers and Investors Alike

- Family Home
- 3 Bedrooms
- Central Location
- Parking for up to 4 Cars
- Downstairs Toilet
- Close to the Motorway for Commuters
- Perfect for First Time Buyers or Investors

Viewing

Please contact our ROK Marsh Office on 02393233267 if you wish to arrange a viewing appointment for this property or require further information.



Floor Plan

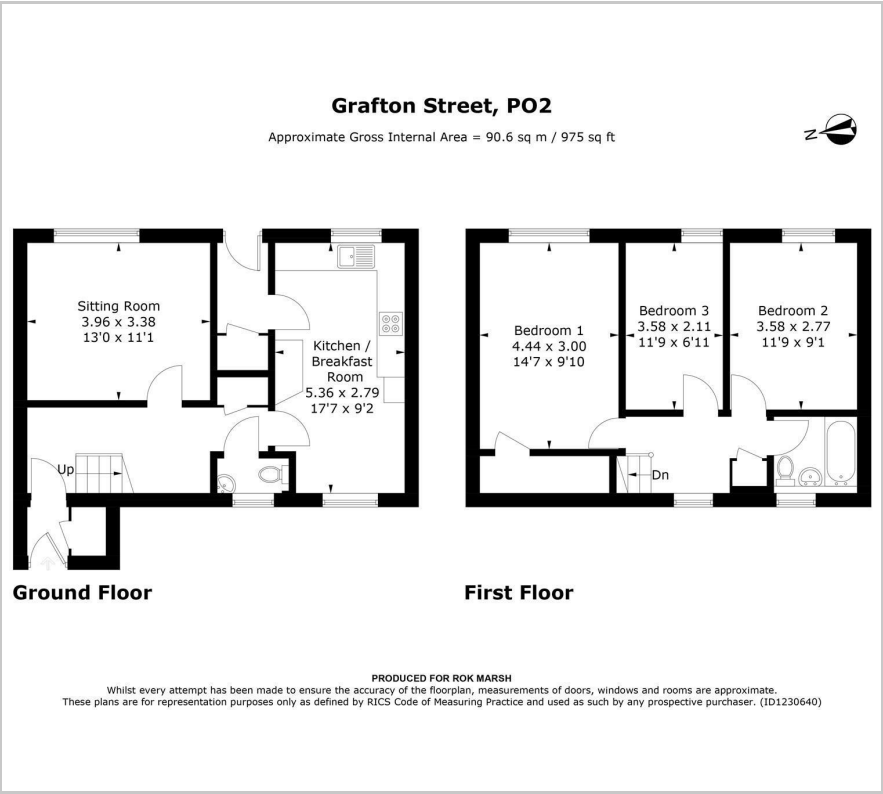

Area Map



Energy Efficiency Graph

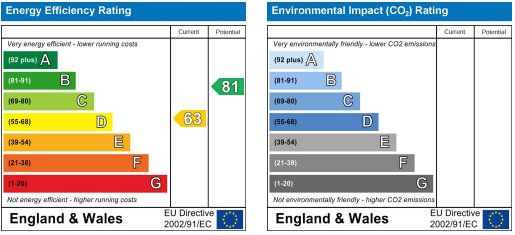

These particulars, whilst believed to be accurate are set out as a general outline only for guidance and do not constitute any part of an offer or contract. Intending purchasers should not rely on them as statements of representation of fact, but must satisfy themselves by inspection or otherwise as to their accuracy. No person in this firms employment has the authority to make or give any representation or warranty in respect of the property.